

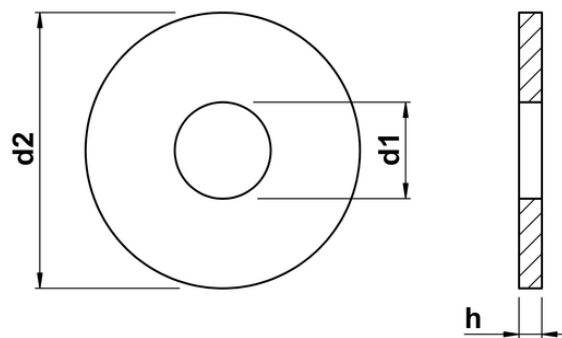

## Washers ISO 7093 part 1 (DIN 9021)

A large diameter washer where the external diameter is typically three times that of the nominal internal diameter. Also known as Form G, and complies with DIN 9021. Please note that due to manufacturing limitations, all nylon variants of these items are only "similar to" and not "in absolute accordance with" the standard specified.



d1	for	d2	h
2.2	M2	7	0.8
2.7	M2.5	8	0.8
3.2	M3	9	0.8
3.7	M3.5	11	0.8
4.3	M4	12	1.0
5.3	M5	15	1.2
6.4	M6	18	1.6
7.4	M7	22	2.0
8.4	M8	24	2.0
10.5	M10	30	2.5
13.0	M12	37	3.0
15.0	M14	44	3.0
17.0	M16	50	3.0
20.0	M18	56	4.0
22.0	M20	60	4.0
26.0	M24	72	5.0
33.0	M30	92	6.0
39.0	M36	110	8.0