

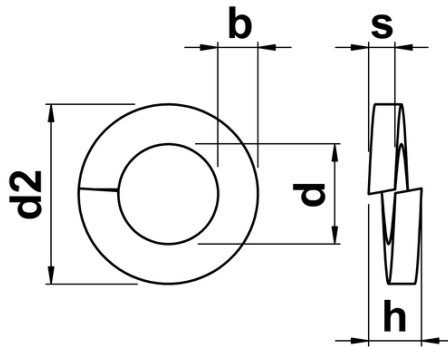

Rectangular Section Spring Washer DIN 127

Spring washer designed to help prevent loosening of bolted joints under vibration. This type has a square section and is manufactured to DIN 127.



nominal size	for	d1	d2	h min.	s	b
2	M2	2.1	4.4	1.0	0.5	0.9
2.3	M2.3	2.3	4.8	1.2	0.6	1.0
2.5	M2.5	2.6	5.1	1.2	0.6	1.0
2.6	M2.6	2.7	5.2	1.2	0.6	1.0
3	M3	3.1	6.2	1.6	0.8	1.3
3.5	M3.5	3.6	6.7	1.6	0.8	1.3
4	M4	4.1	7.6	1.8	0.9	1.5
5	M5	5.1	9.2	2.4	1.2	1.8
6	M6	6.1	11.8	3.2	1.6	2.5
8	M8	8.1	14.8	4.0	2.0	3.0
10	M10	10.2	18.1	4.4	2.2	3.5
12	M12	12.2	21.1	5.0	2.5	4.0
14	M14	14.2	24.1	6.0	3.0	4.5
16	M16	16.2	27.4	7.0	3.5	5.0
18	M18	18.2	29.4	7.0	3.5	5.0
20	M20	20.2	33.6	8.0	4.0	6.0
22	M22	22.5	35.9	8.0	4.0	6.0
24	M24	24.5	40.0	10.0	5.0	7.0
27	M27	27.5	43.0	10.0	5.0	7.0

nominal size	for	d1	d2	h min.	s	b
30	M30	30.5	48.2	12.0	6.0	8.0
33	M33	33.5	55.2	12.0	6.0	10.0
36	M36	36.5	58.2	12.0	6.0	10.0
39	M39	39.5	61.2	12.0	6.0	10.0
40	M40	40.5	63.5	14.0	7.0	12.0
42	M42	42.5	68.2	14.0	7.0	12.0
48	M48	49.0	75.0	14.0	7.0	12.0