

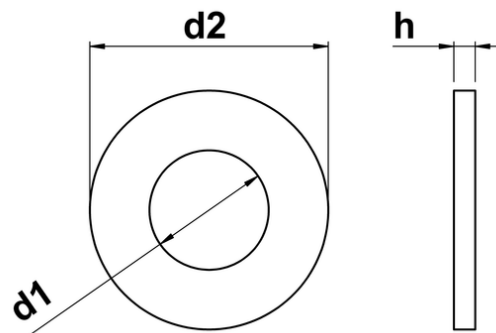

## Flat Washers to US Military Spec 15795

Military specification general purpose imperial sized round washers. Available in corrosion resistant A2 stainless steel and manufactured to US standard MS15795. Please note that these items can have large clearances to the bolt or stud: please refer to the data sheet for further information.



| size                | for use with | d1 (actual) | d1 tol +/- | d2              | d2 tol +/- | h    | h tol +/- | Code |
|---------------------|--------------|-------------|------------|-----------------|------------|------|-----------|------|
| <b>No.4 x 1/4</b>   | No.4         | .125        | .000/.005  | .250 (1/4")     | .000/.005  | .022 | .028/.017 | 803  |
| <b>No.4 x 5/16</b>  | No.4         | .125        | .008/.005  | .312 (5/16")    | .008/.005  | .032 | .040/.025 | 804  |
| <b>No.6 x 5/16</b>  | No.6         | .156        | .008/.005  | .312 (5/16")    | .008/.005  | .035 | .048/.027 | 805  |
| <b>No.6 x 3/8</b>   | No.6         | .156        | .008/.005  | .375 (3/8")     | .015/.005  | .049 | .065/.036 | 806  |
| <b>No.8 x 3/8</b>   | No.8         | .188        | .008/.005  | .375 (3/8")     | .015/.005  | .049 | .065/.036 | 807  |
| <b>No.10 x 7/16</b> | No.10        | .219        | .008/.005  | .438 (7/16")    | .015/.005  | .049 | .065/.036 | 808  |
| <b>No.10 x 9/16</b> | No.10        | .250        | .008/.005  | .562 (9/16")    | .015/.005  | .065 | .080/.051 | 809  |
| <b>1/4 x 5/8</b>    | 1/4          | .281        | .015/.005  | .625 (5/8")     | .015/.005  | .065 | .080/.051 | 810  |
| <b>1/4 x 3/4</b>    | 1/4          | .312        | .015/.005  | .734 (3/4")     | .015/.007  | .065 | .080/.051 | 811  |
| <b>5/16 x 11/16</b> | 5/16         | .344        | .015/.005  | .688 (11/16")   | .015/.007  | .065 | .080/.051 | 812  |
| <b>5/16 x 7/8</b>   | 5/16         | .375        | .015/.005  | .875 (7/8")     | 0.30/.007  | .083 | .104/.064 | 813  |
| <b>3/8 x 13/16</b>  | 3/8          | .406        | .015/.005  | .812 (13/16")   | 0.15/.007  | .065 | .080/.051 | 814  |
| <b>3/8 x 1</b>      | 3/8          | .438        | .015/.005  | 1.000 (1")      | 0.30/.007  | .083 | .104/.064 | 815  |
| <b>7/16 x 15/16</b> | 7/16         | .469        | .015/.005  | .922 (15/16")   | .015/.007  | .065 | .080/.051 | 816  |
| <b>7/16 x 1 1/4</b> | 7/16         | .500        | .015/.005  | 1.250 (1 1/4")  | 0.30/.007  | .083 | .104/.064 | 817  |
| <b>1/2 x 1 1/16</b> | 1/2          | .531        | .015/.005  | 1.062 (1 1/16") | 0.30/.007  | .095 | .121/.074 | 818  |
| <b>1/2 x 1 3/8</b>  | 1/2          | .562        | .015/.005  | 1.375 (1 3/8")  | 0.30/.007  | .109 | .132/.086 | 819  |
| <b>5/8 x 1 5/16</b> | 5/8          | .656        | .030/.007  | 1.312 (1 5/16") | 0.30/.007  | .095 | .121.074  | 820  |
| <b>5/8 x 1 3/4</b>  | 5/8          | .688        | .030/.007  | 1.750 (1 3/4")  | 0.30/.007  | .134 | .160/.108 | 821  |