

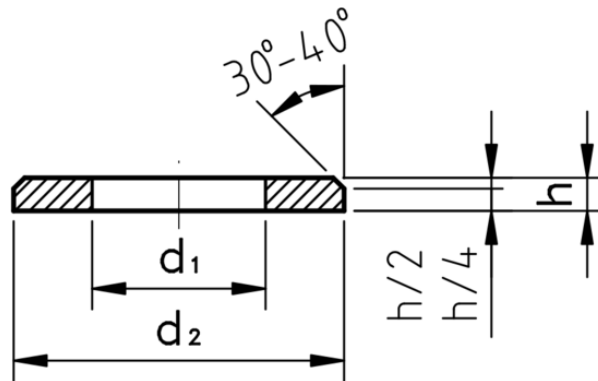

Plain Flat Washer with Chamfered Edge

Simple flat washer with a chamfered edge, similar to DIN 125 Form B type, but made to the newer ISO 7090 standard. Washers are used in nut and bolt assemblies to improve stress distribution on the bearing surface and span large clearance holes. These washers are as standard 200HV hardness grade suitable for hex head bolts, screws and nuts in property classes up to and including grade 8.8. They are also suitable for case-hardened thread rolling screws. Harder 300HV washers also available for use with hex head bolts, screws and nuts in property classes up to and including grade 10.9. They are also suitable for through hardened socket head cap screws, bolts and nuts.



d1	for	d2	h
1.7	M1.6	4.0	0.3
2.2	M2	5.0	0.3
2.7	M2.5	6.0	0.5
3.2	M3	7.0	0.5
3.7	M3.5	8.0	0.5
4.3	M4	9.0	0.8
5.3	M5	10.0	1.0
6.4	M6	12.0	1.6
8.4	M8	16.0	1.6
10.5	M10	20.0	2.0
13.0	M12	24.0	2.5
15.0	M14	28.0	2.5
17.0	M16	30.0	3.0
19.0	M18	34.0	3.0
21.0	M20	37.0	3.0

d1	for	d2	h
23.0	M22	39.0	3.0
25.0	M24	44.0	4.0
28.0	M27	50.0	4.0
31.0	M30	56.0	4.0
34.0	M33	60.0	5.0
37.0	M36	66.0	5.0
42.0	M39	72.0	6.0
45.0	M42	78.0	7.0
48.0	M45	85.0	7.0
52.0	M48	92.0	8.0
56.0	M52	98.0	8.0
62.0	M56	105.0	10.0
66.0	M60	110.0	10.0
70.0	M64	115.0	10.0