

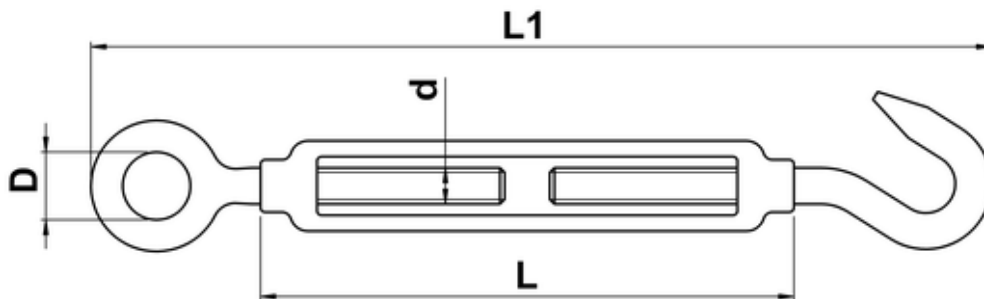

Turnbuckle with Open Body and Eye and Hook

Turnbuckle, used to ensure and adjust tension on roped, cabled, wired or rod systems. Mainly rectangular in shape with threaded inserts at either end. Each end are threaded in opposite directions so that when you rotate the body of the turnbuckle one way tension will be increased, rotate the other way and tension will be released. A versatile fixing which allows for adjustments in precise increments. Uses include boat rigging, tensioning fences, lifting rigs, theatre rigging and even on boxing/wrestling rings! - this version consists of an Eye Bolt and Hook with an open body.



d	L	L1	D
M5	70	120	8
M6	90	150	10
M8	120	200	14
M10	150	240	16
M12	200	310	18
M16	250	390	26
M20	300	440	30