

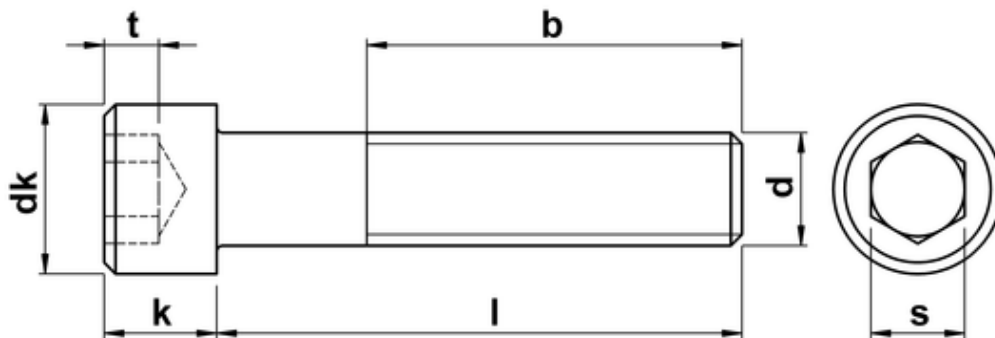

## UNF Socket Head Cap Screws ASME B18. 3-2003

Also known as an Allen screw or Allen bolt, or simply a cap screw, socket head cap screws are a more modern alternative standard machine fastener to the standard hexagon headed bolt or setscrew, as found on much modern machinery. A hex key (otherwise known as an Allen key) is required to fit these fasteners. Conforming to ASME/ANSI B18.3, the contact surfaces of this screw or bolt are protected from external damage. Generally manufactured with a partial thread beyond a certain length and nominal diameter combination, but occasionally some stock may include a fully threaded shank at the same combination.



d	tpi	b	dk	k max.	t min.	s
0-80	80	0.50	0.096	0.060	0.025	0.050
1-72	72	0.62	0.118	0.073	0.031	1/16
2-64	64	0.62	0.140	0.086	0.038	5/64
3-56	56	0.62	0.161	0.099	0.044	5/64
4-48	48	0.75	0.183	0.112	0.051	3/32
5-44	44	0.75	0.205	0.125	0.057	3/32
6-40	40	0.75	0.226	0.138	0.064	7/64
8-36	36	0.88	0.270	0.164	0.077	9/64
10-32	32	0.88	0.312	0.190	0.090	5/32
12-28	28	0.88	0.343	0.216	0.090	5/32
1/4	28	1.0	0.375	0.250	0.120	3/16
5/16	24	1.12	0.469	0.312	0.151	1/4
3/8	24	1.25	0.562	0.375	0.182	5/16
7/16	20	1.38	0.656	0.438	0.213	3/8
1/2	20	1.50	0.750	0.500	0.245	3/8

<b>d</b>	<b>tpi</b>	<b>b</b>	<b>dk</b>	<b>k max.</b>	<b>t min.</b>	<b>s</b>
<b>5/8</b>	18	1.75	0.938	0.625	0.307	1/2
<b>3/4</b>	16	2.00	1.125	0.750	0.370	5/8
<b>7/8</b>	14	2.25	0.312	0.875	0.432	3/4
<b>1</b>	12	2.50	1.500	1.000	0.495	3/4