

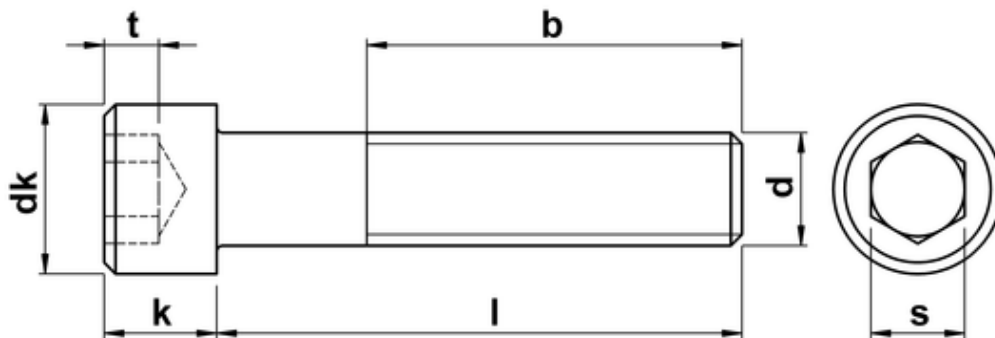

UNC Socket Head Cap Screws ASME B18.3-2012

Also known as an Allen screw or Allen bolt, or simply a cap screw, socket head cap screws are a more modern alternative standard machine fastener to the standard hexagon headed bolt or setscrew, as found on much modern machinery. A hex key (otherwise known as an Allen key) is required to fit these fasteners. Conforming to ASME/ANSI B18. 3, the contact surfaces of this screw or bolt are protected from external damage. Generally manufactured with a partial thread beyond a certain length and nominal diameter combination, but occasionally some stock may include a fully threaded shank at the same combination.



d	tpi	dk	k	t	s	b
1-64	64	0.118	0.073	0.031	1/16	0.62-0.99
2-56	56	0.140	0.086	0.038	5/64	0.62-0.99
3-48	48	0.161	0.099	0.044	5/64	0.62-0.99
4-40	40	0.183	0.112	0.051	3/32	0.75-0.99
5-40	40	0.205	0.125	0.057	3/32	0.75-1.00
6-32	32	0.226	0.138	0.064	7/64	0.75-1.05
8-32	32	0.270	0.164	0.077	9/64	0.88-1.19
10-24	24	0.312	0.190	0.090	5/32	0.88-1.27
12-24	24	0.343	0.216	0.090	5/32	0.88-1.27
1/4	20	0.375	0.250	0.120	3/16	1.00-1.50
5/16	18	0.469	0.312	0.151	1/4	1.12-1.71
3/8	16	0.562	0.375	0.182	5/16	1.25-1.94
7/16	14	0.656	0.438	0.213	3/8	1.38-2.17
1/2	13	0.750	0.500	0.245	3/8	1.50-2.38
5/8	11	0.938	0.625	0.307	1/2	1.75-2.82

d	tpi	dk	k	t	s	b
3/4	10	1.125	0.750	0.370	5/8	2.00-3.25
7/8	9	1.312	0.875	0.432	3/4	2.25-3.69
1	8	1.500	1.000	0.495	3/4	2.50-4.12